

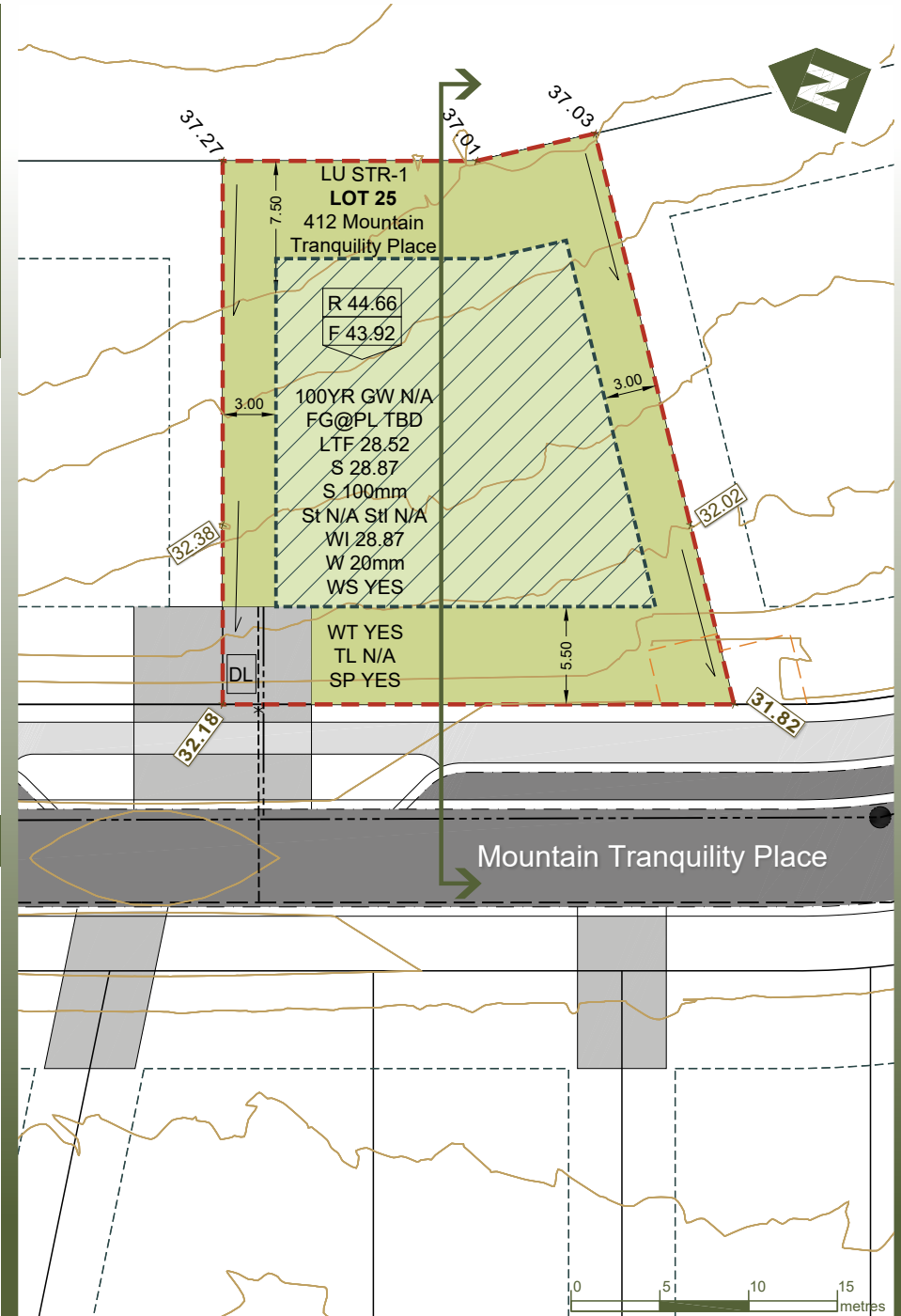

**SILVERTIP**  
CANMORE ★ ALBERTA

## Lot 25, Block 28 LOT LOCATION PLAN

- |  |                              |  |                                    |
|--|------------------------------|--|------------------------------------|
|  | LOT BOUNDARY                 |  | NATURAL AREA                       |
|  | 1.0M CONTOURS                |  | MAXIMUM BUILDING OUTLINE/FOOTPRINT |
|  | PROPERTY LINE                |  | SANITARY SEWER (MANHOLE)           |
|  | RIGHT OF WAY/POCKET EASEMENT |  | SANITARY SERVICE                   |
|  | DRIVEWAY LOCATION            |  | STORM SEWER (MANHOLE)              |
|  | DESIGN FG ELEVATION          |  | WATERMAIN                          |
|  | EXISTING GROUND ELEVATION    |  | WATER SERVICE (VALVE)              |
|  | CONSTRUCTION ENVELOPE        |  | CATCH BASIN                        |
|  | STUDY SECTION LINE           |  |                                    |
|  | ASPHALT SURFACE              |  |                                    |
|  | DRIVEWAY                     |  |                                    |
|  | SIDEWALK                     |  |                                    |
|  | LOT DRAINAGE DIRECTION       |  |                                    |



### BUILDING INFORMATION

### TYPICAL SERVICE DETAIL

VARIES	STREET
59.73	59.73
DL	LOT 1
	CIVIC
F	R
100YR GW	FG@PL
LTF*	
S 1458.91	
S 100mm	
St 100mm	
Sh 1458.98	
Wl 1456.62	
W 20mm P.R.	
WS Y/N	
WT Y/N	
TL	
SP NO	
RMG	
63.69	63.63

- SERVICE LOCATION UNLESS OTHERWISE NOTED
- FRONT ELEVATION AT PL
- LAND USE
- LOT #
- CIVIC ADDRESS
- MAXIMUM BUILDING HEIGHT ELEVATION
- 100YR GROUNDWATER ELEVATION
- RECOMMENDED FRONT GRADE AT HOUSE
- LOWEST TOP OF FOOTING
- SANITARY INVERT AT STUB
- SAN SERVICE SIZE
- STORM SERVICE SIZE (IF APPLICABLE)
- STORM INVERT @ STUB (IF APPLICABLE)
- WATER INVERT @ STUB
- DIAMETER OF WATER SERVICE (P.R.= PRESSURE REDUCTION VALVE)
- WATER SERVICE (COILED AND BOXED)
- WEEPING TILE
- TRAPPED LOW MAX. ELEVATION
- SUMP PUMP FOR WEEPING TILE
- REGISTERED MINIMUM GRADE
- REAR ELEVATION AT PL

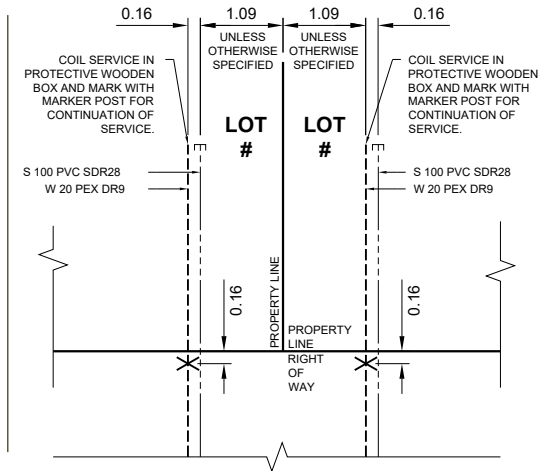

Note: For illustrative purposes only. Not to be used for construction. All grades to be confirmed with Civil Engineer. Do not scale drawing.  
To be read in conjunction with Construction Envelope Study. The developer has the right to modify the drawing to match as built conditions.

Scale 1:400  
March 10, 2023